

MicW® | professional
microphones



E150 Series

Modular microphones
User Manual

MicW®

a division of BSWA Technology Ltd.

Address: Unit 1003, North Ring Center No.18 Yumin Road,
Xicheng District, Beijing 100029, China

Phone: +86-10-5128 5118

Fax: +86-10-8225 1626

Email: sales@micwaudio.com

Web: www.micwaudio.com

MicW microphones

Product features and specifications are subject to change without notice



Perfect for

Acoustic Instruments • Guitar • Piano • Strings •
Drums • Percussion • Brass • Vocals

INTRODUCTION

Welcome to MicW's E-Series professional microphones!

The E150 modular microphone series offers a choice of omni (E153), cardioid (E151) and super-cardioid (E152) condenser capsules combined with a universal, well-designed preamp.

SAFETY INSTRUCTION

It is important to read all the safety and operating instructions before attempting to use your microphone. You are also advised to keep this information for future reference.

Warning:

Condenser microphones are extremely moisture-sensitive. Never use your microphone in close proximity to water (e.g. bath tubs, wash basins, sinks, washing machines, pools, etc.). When recording voices, always use the supplied windscreens to protect the capsule from moisture.

Please don't touch any vibrating parts, especially the diaphragm behind the protection grid. Don't move the capsule when it is in operation. Take care not to drop your microphone as this can lead to severe damage. MicW assumes no liability for any damage caused by the user.

Put the microphone back in its protective casing after each use. Lay the supplied bag of moisture-absorbing crystals on top of the microphone head.

POWER SUPPLY

Phantom power (+48 V) is required in order to operate your microphone. We assume no liability for damage caused to your microphone through defective phantom power. Before activating the phantom power, mute your playback system and connect the microphone to the mic input of your mixing console. After the phantom power has been activated, the microphone will require several seconds to stabilize itself.



APPLICATIONS

E150 Series microphones are widely used for recording acoustic instruments, guitar, piano, strings, drums, percussion, brass and vocals.

• Instrument recording



• Vocal recording



MICROPHONE INSTALLATION



First attach the microphone capsule then screw a clamp onto the stand.

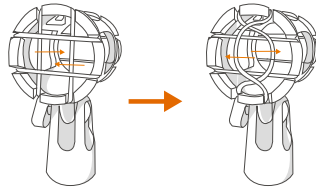

If the microphone is not stable, you could cross the elastic band to hold it firm.

AUDIO CONNECTION

To connect the microphone to your equipment, use a balanced XLR microphone cable with the following pin assignment: Pin 1 = shielding, pin 2 = +, pin 3 = -. Since all the microphone contact points are gold-plated, your microphone cable should also have gold-plated connectors, if possible.

Directional characteristic

• E151

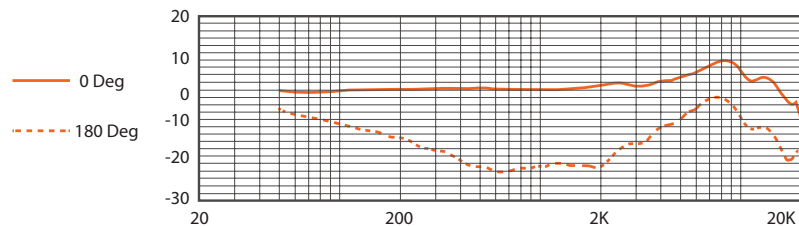

• E152

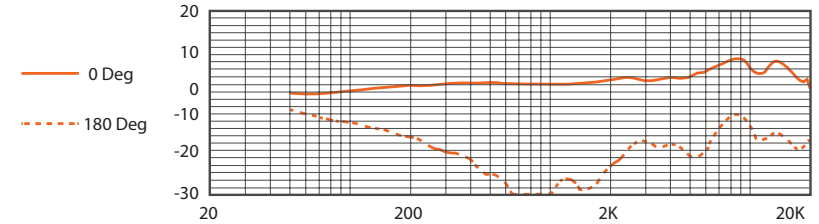

• E153

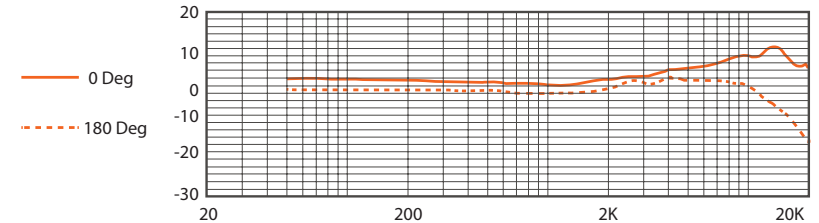

SPECIFICATIONS

Capsule

	E151	E152	E153
Polar pattern	Cardioid	Super-cardioid	Omni
Capsule diameter	20 mm		
Sensitivity (± 3 dB)	-42 dB re. 1v/Pa		
Frequency Response	20 Hz ~ 20kHz		
Power Supply	48 V Phantom power		
Total harmonic distortion (THD)	< 1% up to 135 dB SPL peak		
Thermal Noise	< 17 dBA		
Output impedance	< 100 Ohm		
Length	155mm		
weight	185g		
Connector	3-pin XLR		

WARRANTY POLICY

MicW Audio warrants that its products will be free from defects in materials and workmanship for one (1) year from the date of purchase by the Original Purchaser.

WHAT'S IN THE BOX

The following packages cater for a range of recording applications and are highly recommended for students and start-up engineers:

• E151

- Microphone Preamplifier
- Cardioid capsule
- Windscreen
- Shock Mount
- User manual



• E152

- Microphone Preamplifier
- Super-Cardioid capsule
- Windscreen
- Shock Mount
- User manual



• E153

- Microphone Preamplifier
- Omni capsule
- Windscreen
- Shock Mount
- User manual



• E150 set1

- Microphone Preamplifier
- Cardioid capsule
- Super-Cardioid Capsule
- omni capsule
- Windscreen
- Shock Mount
- Box
- User manual



• E150 pair set2

- 2 x Microphone Preamplifiers
- 2 x Cardioid Capsules
- 2 x Super-Cardioid Capsules
- 2 x Omni Capsules
- 2 x Windscreens
- 2 x Shock Mounts
- User Manual

